

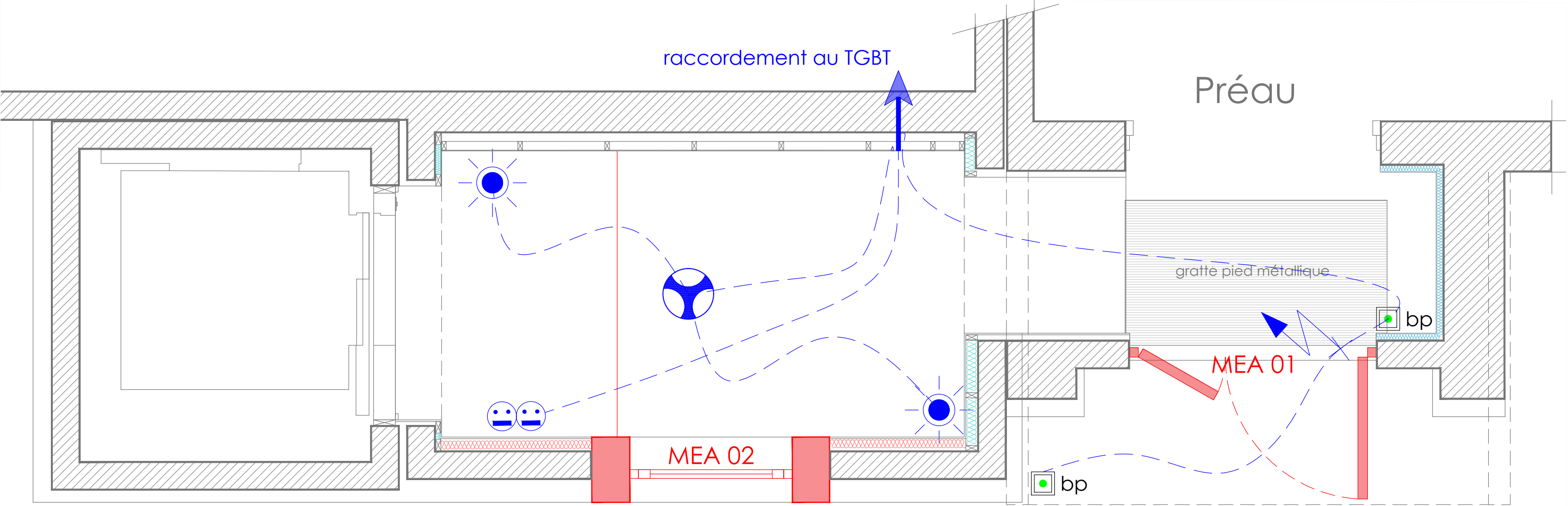





Projet réseau électrique





LEGENDE

-  Plafonnier encastré de type Luminance Giotto LED 305 G2 19W 1960 lm
-  Détecteur de présence en plafond 360°
-  PC DOUBLE 2P+T 10/16A
-  Alimentation électrique en attente
-  bp bouton poussoir PMR pour porte motorisée (IP65 en extérieur)

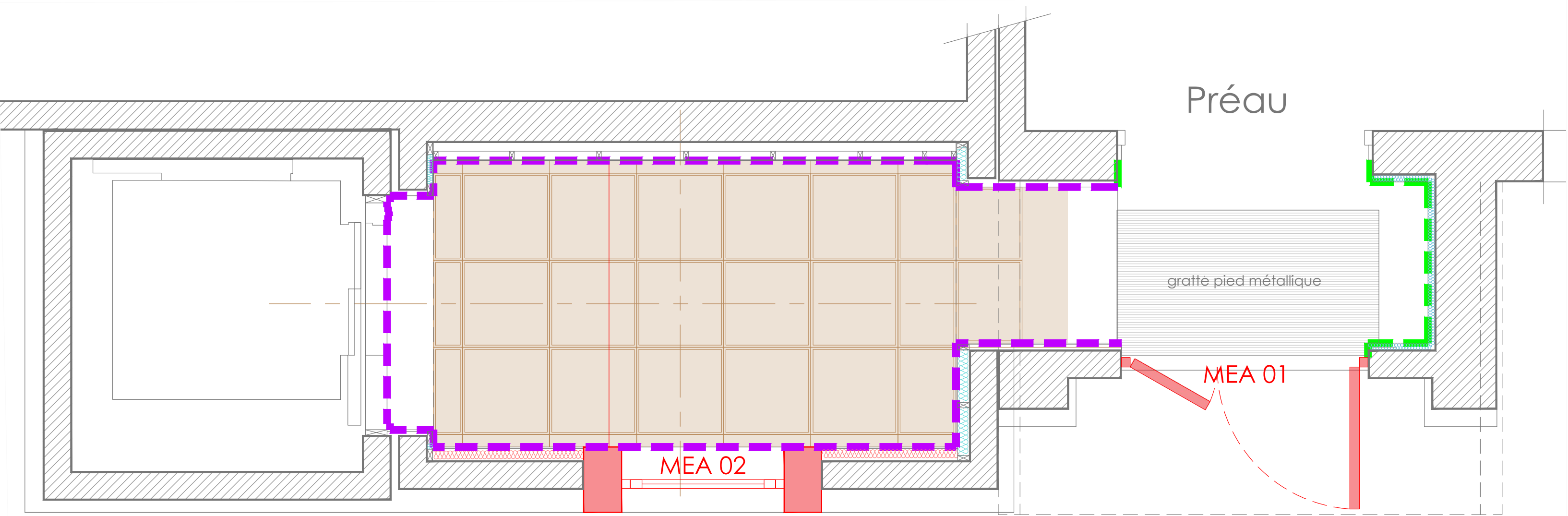
Reprise des surfaces

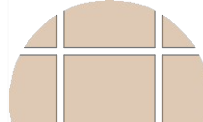

-  reprise complète des parois + peinture
-  peinture seule
-  plafond & faux plafond à reprendre